



## METAXDOOR HM30/CRS

Automatic Circular Sliding Door



Revolving Doors



Sliding Doors



Swing Doors





Full Circular Automatic Sliding Door



Half Circular Automatic Sliding Door



Segmented Circular Automatic Sliding Door

*You Dream,  
We Build*

**Metaxdoor HM30/CRS** automatic circular sliding doors, which can be used indoors and outdoors, provide you with special multi dimensional solutions with various application alternatives and architectural details.



**METAXDOOR** HM30/CRS can be designed as half circular, full circular or segmented. Segmented versions can be produced as inwards or outwards with single parting or bi-parting modes available for both models.

These entrance systems, which are easily adapted to your architectural concept are attractive and encourage people to walk through the door. With different shapes of application it can easily be adapted to facades and alternatives entrances.

The most important features of **METAXDOOR** HM30/CRS automatic circular sliding door are being useful for high pedestrian traffic and perfect adaptation with the ambiance they are in.



| D    | D1   | D2   | W    | H         | K        |
|------|------|------|------|-----------|----------|
| 2000 | 1966 | 1806 | 1250 | 2100-3100 | 200-1000 |
| 2200 | 2166 | 2006 | 1390 | 2100-3100 | 200-1000 |
| 2400 | 2366 | 2206 | 1530 | 2100-3100 | 200-1000 |
| 2600 | 2566 | 2406 | 1680 | 2100-3100 | 200-1000 |
| 2800 | 2766 | 2606 | 1820 | 2100-3100 | 200-1000 |
| 3000 | 2966 | 2806 | 1960 | 2100-3100 | 200-1000 |
| 3200 | 3166 | 3006 | 2100 | 2100-3100 | 200-1000 |
| 3400 | 3366 | 3206 | 2240 | 2100-3100 | 200-1000 |
| 3600 | 3566 | 3406 | 2380 | 2100-3100 | 200-1000 |
| 3800 | 3766 | 3606 | 2520 | 2100-3100 | 200-1000 |
| 4000 | 3966 | 3806 | 2660 | 2100-2500 | 200-1000 |
| 4200 | 4166 | 4006 | 2800 | 2100-2500 | 200-1000 |
| 4400 | 4366 | 4206 | 2950 | 2100-2500 | 200-1000 |

\* Dimensions are in millimeters.

\*\* Dimensions are for reference and subject to change according to requirements.

\*\*\* Special dimensions are available according to requirements.

### Design and Alternatives

| Basic Configuration           | Half Circular             | Segment             | Full Circular           |
|-------------------------------|---------------------------|---------------------|-------------------------|
| out                           |                           |                     |                         |
| in                            |                           |                     |                         |
| Design Options                | Half circular combination | Segment combination | 3 entries full circular |
| out                           |                           |                     |                         |
| in                            |                           |                     |                         |
| Half circular combination     |                           |                     |                         |
| Segment combination           |                           |                     |                         |
| 3 entries full circular       |                           |                     |                         |
| asymmetric side full circular |                           |                     |                         |

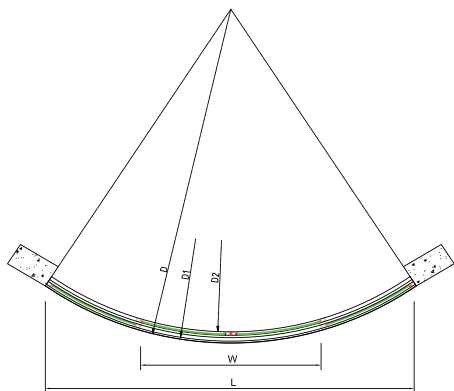

D: Outer Canopy Diameter  
D1: Outer Ground Diameter  
D2: Inner Diameter  
W: Clear Passage  
L: Length  
H: Height

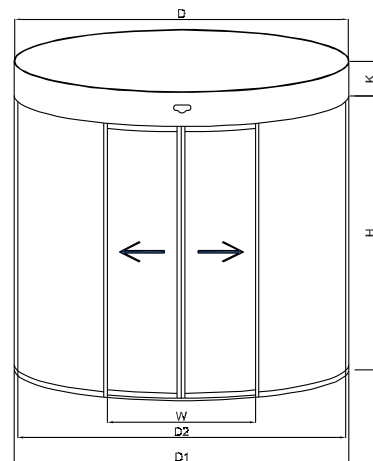
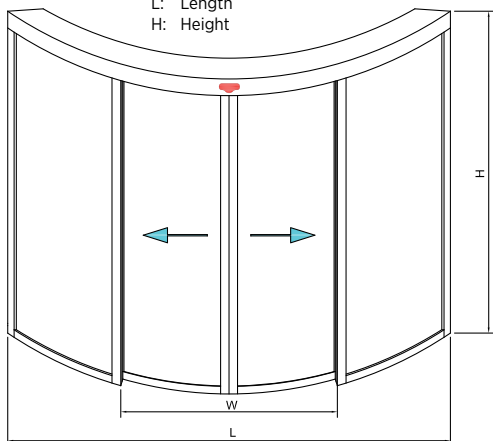

D: Outer Canopy Diameter  
D1: Outer Ground Diameter  
D2: Inner Diameter  
W: Passage Width  
H: Passage Height  
K: Canopy Height

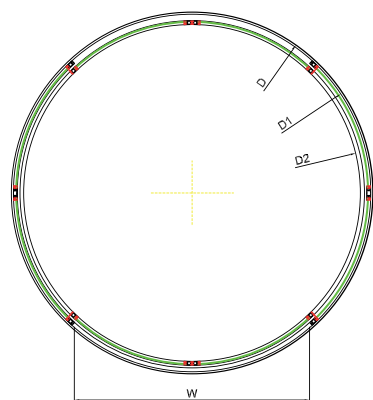

### Technical Specifications

|   |                           |                           |
|---|---------------------------|---------------------------|
| Processor                                       | COMBO v3.0                |                           |
| Motor   | 36 V DC                   |                           |
| Max Absorbed Power                              | 140                       |                           |
| Power Supply Voltage                            | 230 V - (+6%-10%) 50Hz    |                           |
| Operating Ambient temperature                   | -20 °C - +55 °C           |                           |
| Pulley System                                   | 3 Wheel Pulley            |                           |
|   | Single Leaf               | Double Leaf               |
| Max. Leaf Weight (kg)                           | 200 kg                    | 2 x 120 kg                |
| Passage Opening                                 | 0-3000                    | 0-3000                    |
| Stand-by Power Without Accessories              | 3                         | 3                         |
| Use Frequency                                   | 100%                      | 100%                      |
| Length (mm)                                     | From 1500 to 6100         | From 1700 to 6100         |
| Max. Framed Leaf Thickness                      | 30 mm                     | 30 mm                     |
| Max. Accessories Load                           | 1A, 24 V                  | 1A, 24 V                  |
| Time/Date Backup Battery                        | Lithium CR2032 3V         | Lithium CR2032 3V         |
| Motion Backup Battery                           | NiMh 24V 1800mAh          | NiMh 24V 1800mAh          |
| Traction  | By toothed belt           | By toothed belt           |
| Opening/Closing Speed Adjustment (empty) [cm/s] | 10...75                   | 20...150                  |
| Partial Opening Adjustment                      | 5%...95% of total opening | 5%...95% of total opening |
| Pause Time Adjustment [s]                       | 0...30                    | 0...30                    |
| Anticrushing Safety Device                      | in opening/closing        | in opening/closing        |
| Protection Sensors Monitoring [EN 16005:2012]   | can be bypassed           | can be bypassed           |
| Automation Protection Rating                    | IP 23 (internal use)      | IP 23 (internal use)      |
| Mechanical Specifications                       |                           |                           |
| Stainless Steel Cladding                        | Optional                  |                           |
| Electronic Lock                                 | Optional                  |                           |
| Protection Sensor                               | Optional                  |                           |
| UPS   | Optional                  |                           |

\*Please contact us for special designs according to your projects.





### Segment Automatic Sliding Door

The doors can be manufactured according to the exact size of the space required and applied as bi-directional or uni-directional with or without fixed drums. The design alternatives and their forms make it possible to apply these doors in curved entrances.

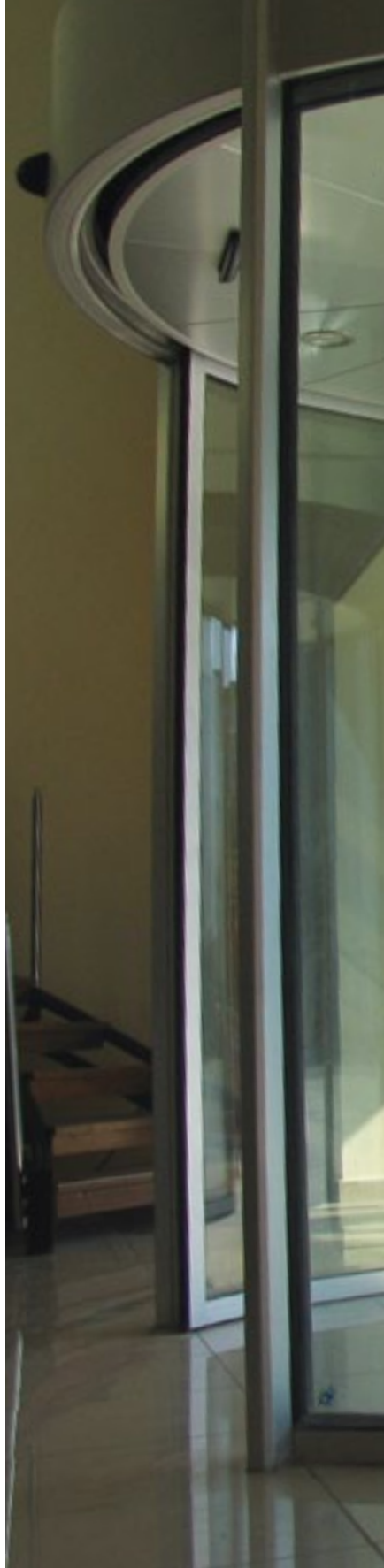

### Combined Radars

They are activation radars with safety sensors which are used for METAXDOOR automatic sliding door systems.



### Half Circular Automatic Sliding Door

Half circular automatic sliding door, which is one of METAXDOOR MS30/CRS series, can be used to complete an arched facade or create a concave or convex entrance on a flat facade. It can be manufactured in different radius sizes and provide various solutions.

## CORE KIT

01



Including, Combo2 Operator, Brushed DC Motor, SMPS.

## Air Curtain

02



## Radar

03

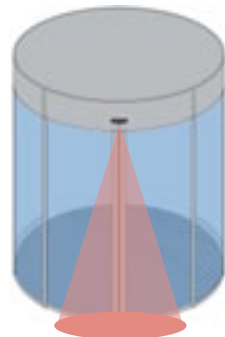

## Optical Safety Sensor

04

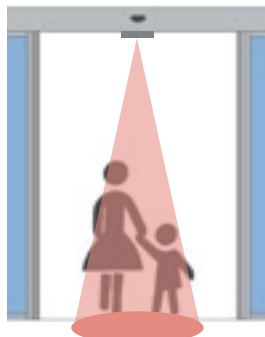

## Light

05



02

06

03

04

04

05

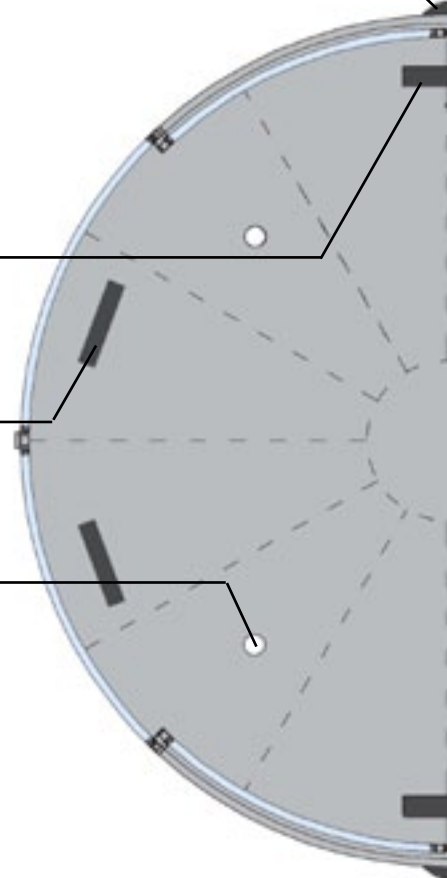
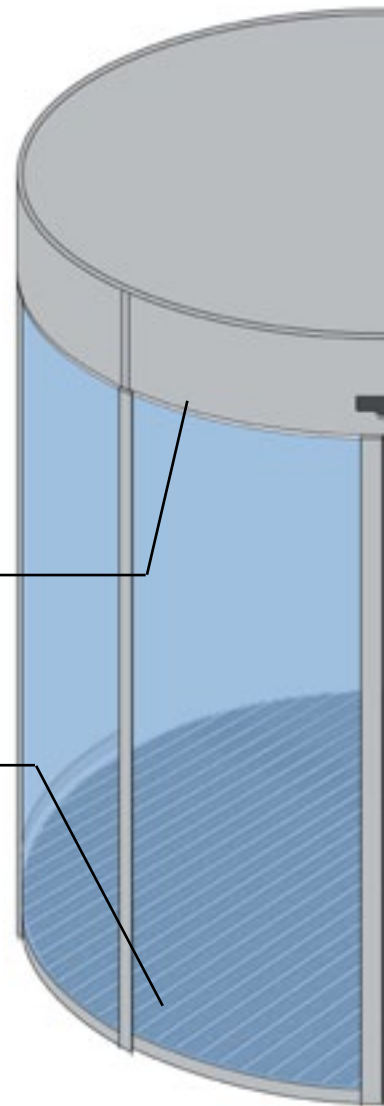

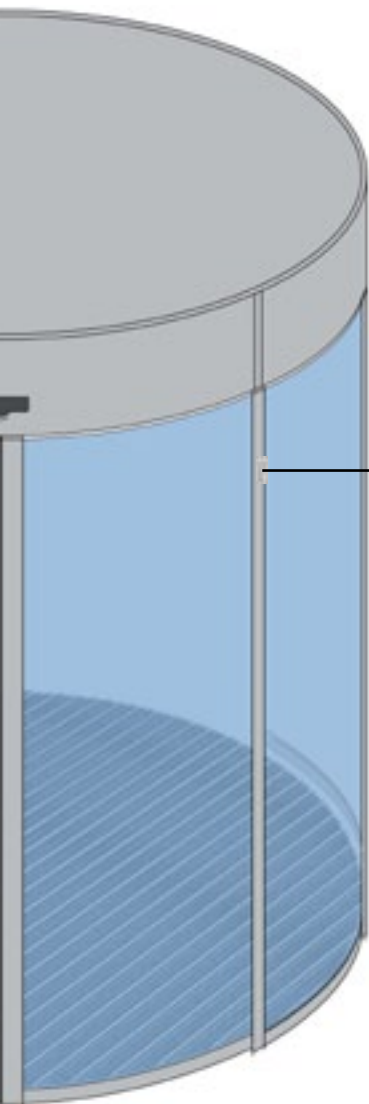

Position Switch

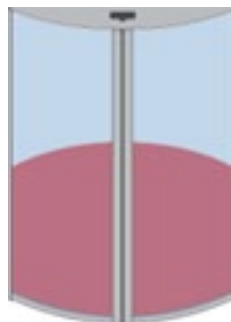

Floor Mat

06



Floor Mat

07

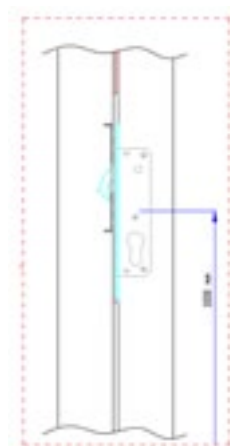
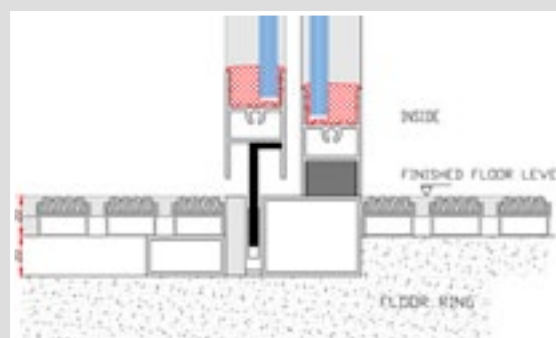

Manuel Lock

08

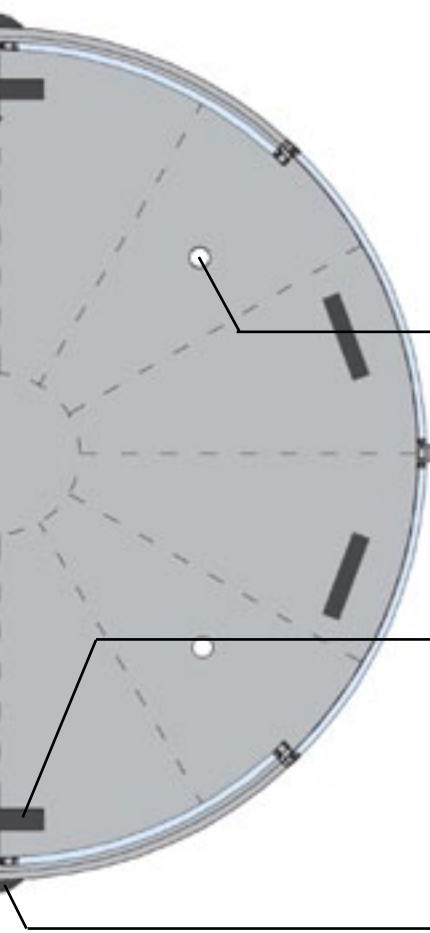

05

04

03

|                      | Half circle                             | Segment   | Full circle                     |
|----------------------|---|---|---------------------------------|
| Basic Configurations |   |   |                                 |
| Design Options       | <br>Half circle combination             | <br>Segment combination                         | <br>3 entries full circle       |
|                      | <br>inside building concave half circle | <br>inside building segment concave half circle | <br>asymmetric side full circle |



HTM METAXDOOR GmbH  
Bredeneyer Str. 2b 45133 Essen  
Tel : 0201 4517-322 • Fax: 0201 4517-323  
[www.metaxdoor.de](http://www.metaxdoor.de) • [info@metaxdoor.de](mailto:info@metaxdoor.de)

© HTM METAXDOOR GmbH all rights reserved. | Ver.15.02.18.HM30/CRS.EN.UK.04

